

RECESSED WALL NICHE
MODEL 7TRT1 or 2

If you need assistance with installation, replacement parts or have any questions regarding your Rubinet product, please call a Customer service representative at: 905-851-6781 toll free 1-800-461-5901 or visit www.rubinet.com

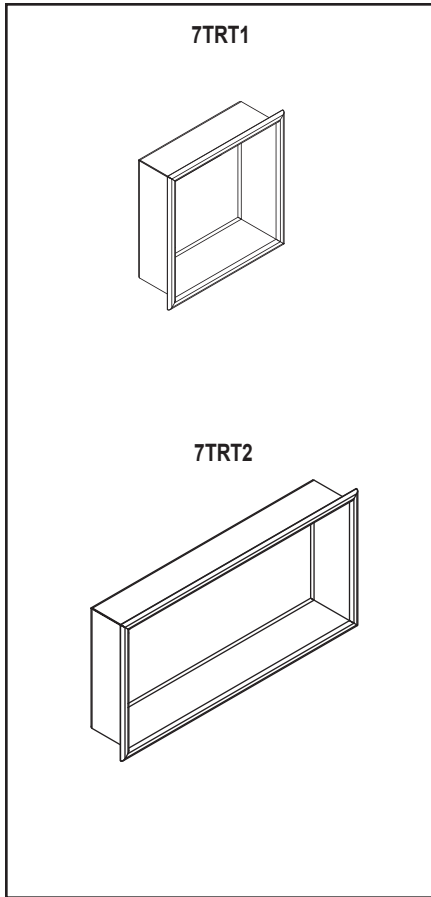

BEFORE YOU BEGIN:

READ ALL INSTRUCTIONS PRIOR TO INSTALLATION.

- Observe and adhere to all local building and plumbing codes.
- If this is a new installation, we recommend boxing the hole size required for maximum support.
- If this is a retro fit installation, make absolutely sure there are no obstructions behind the wall where you intend to mount the Niche Shelf.

SPECIFICATIONS:

Stainless steel construction
Overall size 12" x 12" or 12" x 24"
Hole size 10 3/4" x 10 3/4" or 10 3/4" x 22 3/4"
Comes with double sided foam tape installed

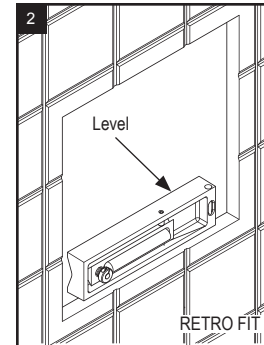
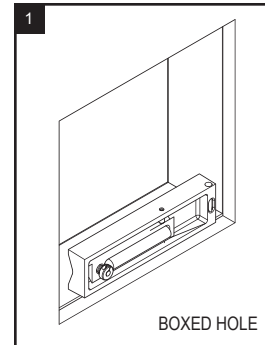

Make sure the bottom edge of the hole is perfectly level.

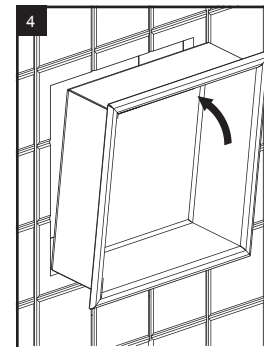
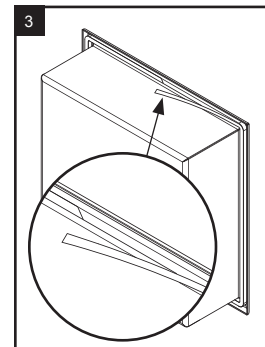

Remove the peel-off backing on the double sided foam tape attached to the back of the Recessed Wall Niche.

Rest the bottom of the Recessed Wall Niche on the bottom edge of the hole as shown to ensure it is level.

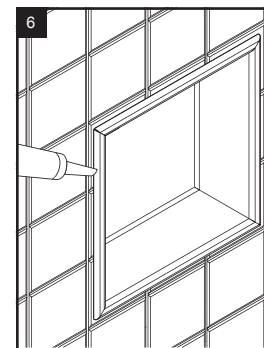
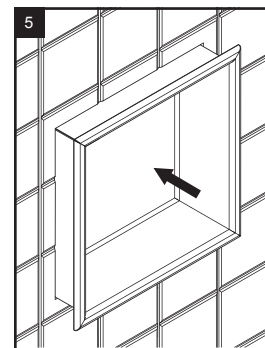

Push the Recessed Wall Niche firmly back and ensure the double sided foam tape has adhered all the way around the unit.

To ensure a water tight seal, you must apply caulk (not supplied) around the outside edge of the unit as shown.