

**FLOOR MOUNT TUB FILLER WITH HAND HELD SHOWER  
MODEL 3FRBRVL**

If you need assistance with installation, replacement parts or have any questions regarding your Rubinet product, please call a Customer service representative at: 905-851-6781 toll free 1-800-461-5901 or visit [www.rubinet.com](http://www.rubinet.com)

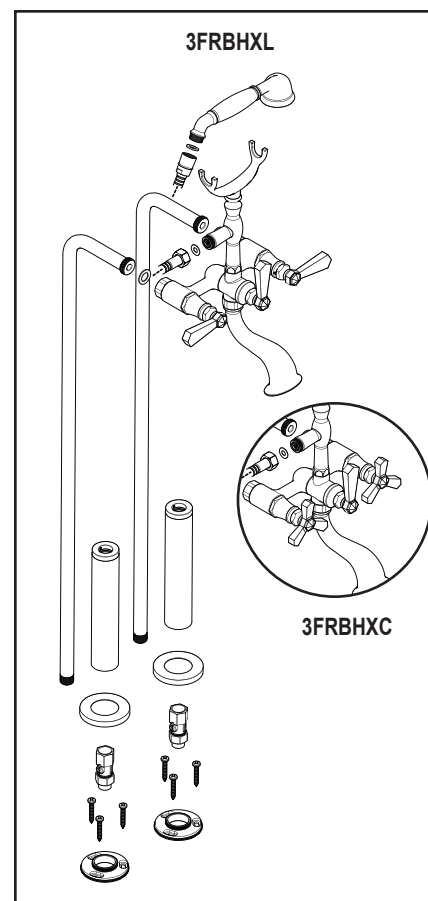

**IMPORTANT:**

Observe all local plumbing and building codes.

Shut-Off the main water supply.

**REMOVAL OF FAUCET:**

Always turn the water supply off before removing the existing faucet or disassembling a valve. Open both faucet handles to relieve water pressure and to ensure that the water has been successfully turned off.

**CARE OF FAUCET:**

The use of warm water and a soft cloth is all that is required to clean Rubinet products. The patina of our living finishes (Oil Rubbed Bronze & Tuscan Brass) will change as a result of normal use. Applying Mineral Oil on occasion will create a softer look, subtle color changes and character.

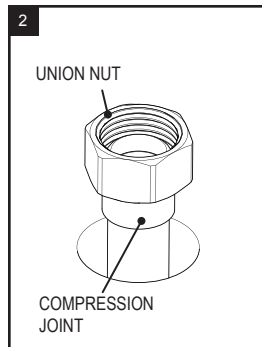
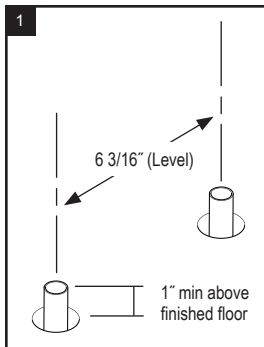

Determine the desired location for this faucet and position the 1/2" copper water supply pipes 6 3/16" apart. Cut the copper pipes a minimum of 1" above the finished floor making sure they are perfectly level.

Assemble the Union Nut on each pipe first then solder the Compression Joint to the top of each pipe.

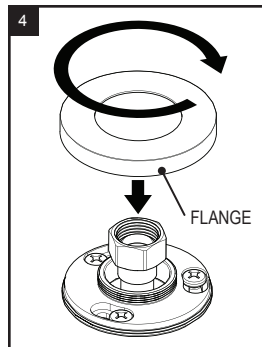
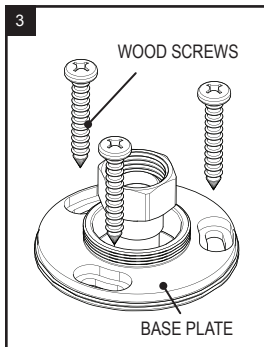

Centre each Base Plate over the supply pipes and screw them to the floor as shown.

Then screw the Flange onto each Base Plate.

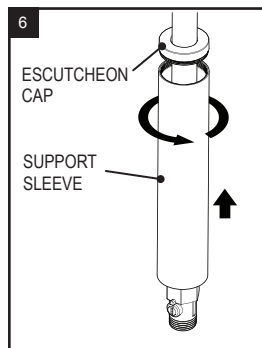
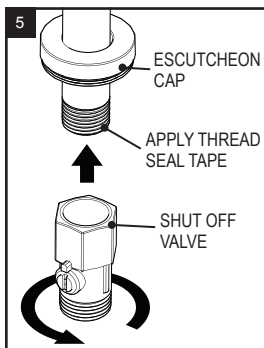

Thread the Escutcheon Cap onto each Leg Riser. Apply Thread Seal Tape to the NPT thread at the end of each Leg Riser and install the Shut-Off Valve.

Next screw the Support sleeve to the Escutcheon Cap. Push the Support Sleeve assembly up the leg just far enough to expose the Shut-Off Valve.

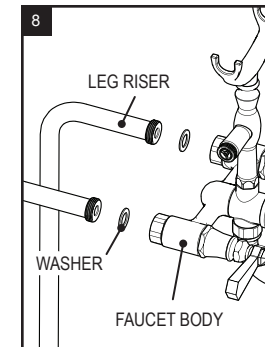
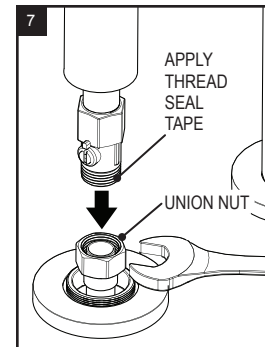

Apply Thread Seal Tape to the NPT thread of each Shut-Off Valve and assemble the Leg Risers onto the Union Joints. Tighten the Union Nut finger tight to allow for adjustment of the Leg Risers when assembling the Faucet Body.

Now assemble the Faucet Body to the Leg Riser as shown with the 3/4" Rubber Washer to seal the joint. When satisfied with the faucet alignment tighten the Union Nuts firmly.

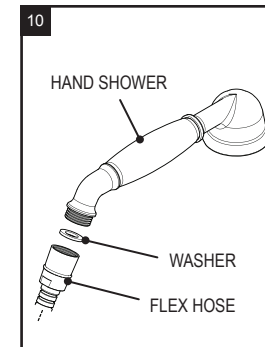
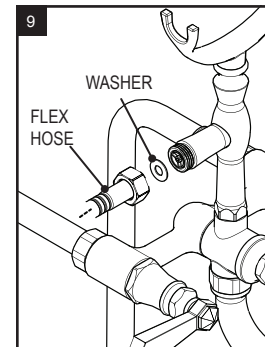

Assemble the end of the Flex Hose with the Knurled Nut to the Faucet Body as shown and the Cone end to the Hand Shower.

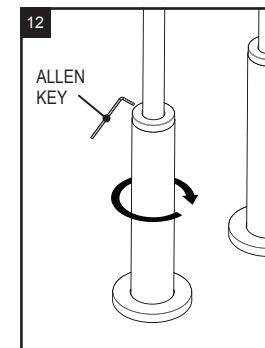
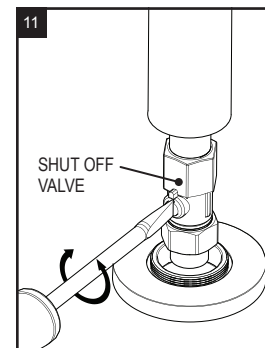

Make sure the Shut-Off Valves are turned off (in the horizontal position) before turning on the main water supply. Check for leaks up to this point. If there are no leaks turn the Shut-Off Valves on (in the vertical position) and check for leaks beyond the Shut-Off Valves before finally assembling the Support Sleeves.

Screw the Support Sleeves to the Base Plates and secure with the Set Screw in the Escutcheon Cap using the Allen Key provided.